

Frascio®

Architectural Door Pulls



FR International

FRInternational LLC
www.FRInternational.com



Company Focus



FR International is a leading manufacturer and distributor of decorative door hardware trim, with a globally recognized project base. Our Frascio brand name has over 70 years of history providing decorative handles and pulls for high end commercial and fine residential buildings worldwide. Our years of experience have been spent developing and improving designs and manufacturing efficiency, allowing us to offer you outstanding product quality and value.

FR International is pleased to present this Architectural Door Pulls catalog to illustrate and explain a portion of the design range and broad manufacturing capability we have. Door pulls continue to grow in popularity as sliding door systems are increasingly specified in the architectural and interior design community.

There are limitless opportunities for creative expression and technical variation in the world of decorative door pulls.

Environmentally-Friendly Manufacturing

Frascio door pulls are manufactured primarily from stainless steel, aluminum, and brass. The percentage of postconsumer and post-industrial recycled content is estimated as follows:

-  Stainless steel that is used in Frascio products has a post-industrial recycled content of approximately 70%, and a post-consumer recycled content of approximately 8%.
-  The aluminum and brass materials that are used to make many Frascio products typically contain 80-100% recycled material, a combination of melted scrap metal and reclaimed by-products.

The above percentages show an average of Frascio's overall production. Actual percentages on any order will vary based on the specific products that comprise that order as well as the mill source.

When no longer needed, Frascio stainless steel, aluminum and brass parts are 100% recyclable.

Frascio is committed to responsible business and manufacturing practices that help conserve resources and protect our environment.

Materials and Finishes

Architectural pulls are most frequently fabricated in stainless steel material. Most of the pulls shown in this catalog are available in stainless steel, and depending on the specific design may also be available in other materials such as brass or aluminum. Solid cast bronze is also an option in some cases.

Our standard stainless steel alloy grade used for architectural pulls is 304, which is perfect for most indoor environments and many exterior environments. For applications where air pollution and marine salt air is prevalent, consider specifying alloy grade 316, which has an even higher degree of corrosion protection.

In addition to alloy grade selection, the surface finish of stainless steel can affect corrosion resistance, as smooth polished surfaces deflect the deposit of airborne debris that can lead to corrosion better than a satin surface. For optimal resistance to surface stains caused by corrosion, specify polished finish.

The most common finishes provided in stainless steel material are BHMA 630 Satin Stainless and BHMA 629 Polished Stainless. Other standard BHMA finishes can also be created by applying coatings to the stainless steel or brass base material. Refer to the FR International Finishes Chart as a reference.

Custom finishes are also available upon request.

Our Product Nomenclature and Identification System

FR International organizes its door pull identification system around two primary characteristics of the pull; the **Cross Section Shape of the Grip** and the **General Design Style**.

Grip Cross Section

For categorization purposes, grip cross sections are organized into 5 options, with a corresponding Alpha character assigned to each. This alpha character provides an important designation in our nomenclature for specification and ordering purposes.

A Round

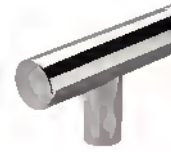

B Square

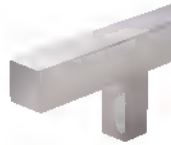

C Rectangular

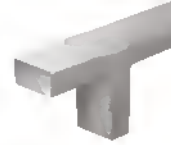

D Oval

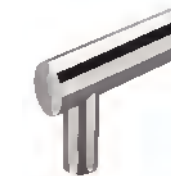

E Varied*



* A grip cross section is considered "Varied" if it is asymmetric or if there is more than one shape incorporated into the grip portion of the pull.

General Design Style

For this second identifying characteristic, we organize the style of pull into one of three general category options, with a numeric character assigned to each. This numeric character is also used as an important designation in our nomenclature for specification and ordering purposes.

1 Infinity Mounted

An Infinity mounted pull is one where both ends of the pull grip terminate into the door surface.



4 Standoff Mounted

The term Standoff is used to describe a mounting posts fastened to the grip as a separate component. In this style, the ends of the pull grip do NOT terminate into the door surface.



7 Sculpted

This term is used to describe contoured cast, asymmetric, and other creative design shapes beyond simple geometric shapes and components.



Fastening Systems

Standard Mounting Types

Four typical mounting types are shown below for consideration. Each has a corresponding alpha character used in our nomenclature for specification and ordering purposes. Other mounting options are also available upon request to accommodate specific substrate materials and project conditions.

A. Concealed Surface Mounting

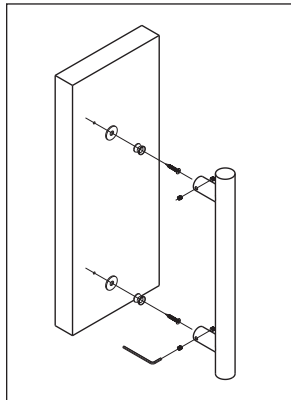

B. Throughbolt Mounting

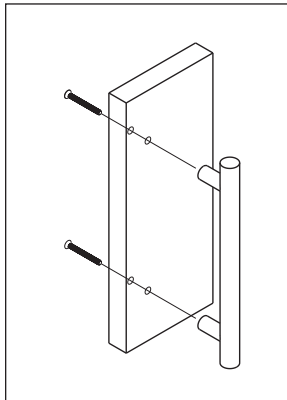

C. Finished Head Throughbolt Mounting

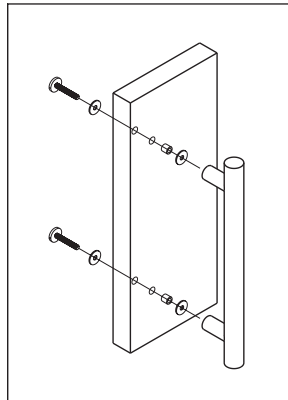

D. Back-To-Back Mounting

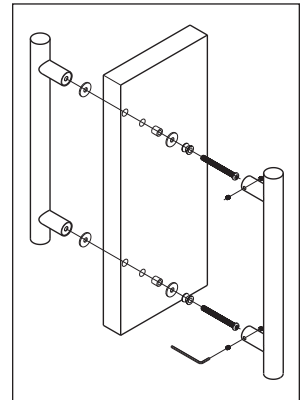

Base Plate Rosettes

Optional base plate rosettes are available for standard round standoff posts that provide function and additional stability. Designate "with rosette" for rosettes in the "Other" column if desired

How to Specify and Order

Shown below is the typical format for specifying and ordering door pulls:

Product Category	Grip Cross Section Shape	Style	Pull Number (3 digits)	CTC/OAL (mm)	Finish	Mounting Type	Door Thickness	Other
DP	A	1	000	475/500	630	A	1-3/4	
DP Door Pull	A Round B Square C Rectangular D Oval E Varied	1 Infinity Mounted 4 Standoff Mounted 7 Sculpted	Refer to catalog model number		629 630	A Concealed B Throughbolt C Finished Head D Back-to-Back		

INFINITY MOUNTED PULLS

Infinity mounted pulls have a shape that allows both ends of the pull grip to flow directly into the door surface.



ROUND GRIP CROSS SECTION PULLS

INFINITY MOUNTED—STRAIGHT PULLS

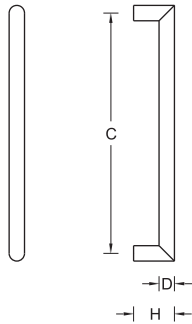

Model	D	H	C
DPA1000	∅ 25mm	70mm	Per project spec
DPA1027	∅ 32mm	80mm	Per project spec

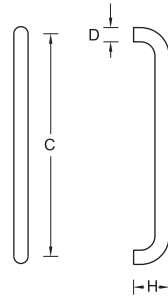

Model	D	H	C
DPA1001	∅ 25mm	75mm	Per project spec
DPA1006	∅ 32mm	80mm	Per project spec

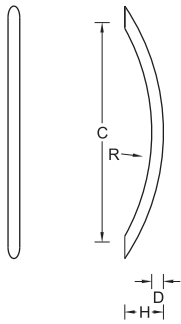

Model	D	H	C and R
DPA1002	∅ 19mm	55mm	Per project spec
DPA1064	∅ 32mm	106mm	Per project spec

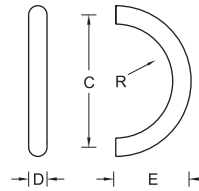

Model	D	H	C and E
DPA1011	∅ 25mm	78mm	Per project spec

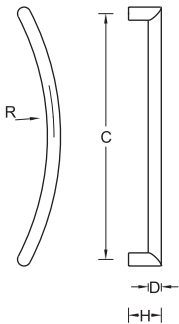

Model	D	H	C and R
DPA1043	∅ 20mm	70mm	Per project spec
DPA1044	∅ 32mm	80mm	Per project spec

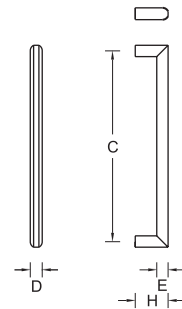

Model	D	H	C and E
DPA1062	∅ 32mm	80mm	Per project spec
DPA1063	∅ 25mm	70mm	Per project spec

ROUND GRIP CROSS SECTION PULLS

INFINITY MOUNTED—STRAIGHT PULLS

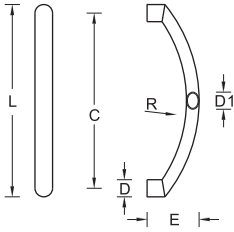

Model	D	H	C and R
DPA1066	∅ 25mm	65mm	Per project spec

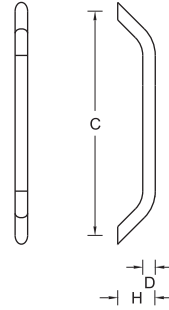

Model	D	H	C
DPA1102	∅ 25mm	75mm	Per project spec

SQUARE GRIP CROSS SECTION PULLS

INFINITY MOUNTED—STRAIGHT PULLS

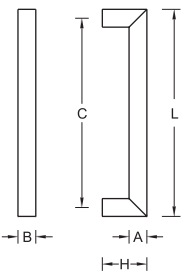

Model	A	B	H	C
DPB1000	25mm	25mm	70mm	Per project spec

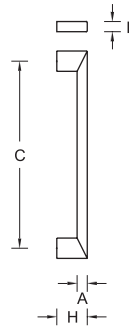

Model	A	B	H	C
DPB1005	19mm	19mm	57mm	Per project spec

SQUARE GRIP CROSS SECTION PULLS

INFINITY MOUNTED—STRAIGHT PULLS

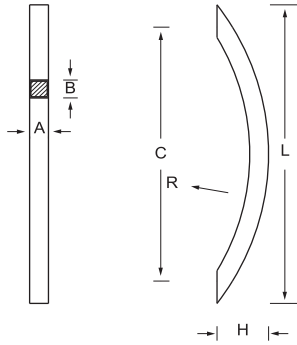

Model	A	B	H	C and R
DPB1006	19mm	19mm	52mm	Per project spec

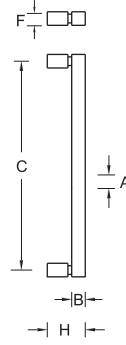

Model	A	B	H	C
DPB1007	25mm	25mm	70mm	Per project spec

RECTANGULAR GRIP CROSS SECTION PULLS

INFINITY MOUNTED—STRAIGHT PULLS

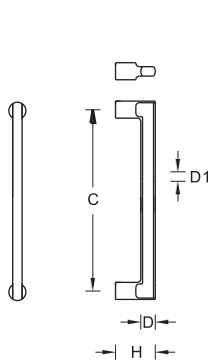

Model	D	D1	H	C
DPC1001	20mm	13mm	55mm	Per project spec

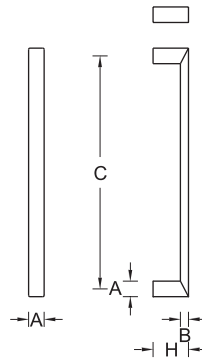

Model	A	B	H	C
DPC1002	25mm	13mm	58mm	Per project spec
DPC1024	30mm	15mm	60mm	Per project spec

RECTANGULAR GRIP CROSS SECTION PULLS

INFINITY MOUNTED—STRAIGHT PULLS

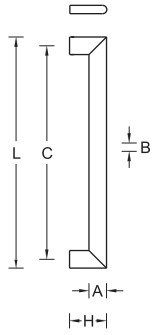

Model	A	B	H	C
DPC1003	38mm	18mm	83mm	Per project spec

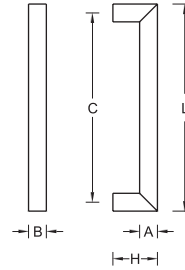

Model	A	B	H	C
DPC1008	13mm	25mm	58mm	Per project spec
DPC1009	25mm	13mm	70mm	Per project spec
DPC1010	38mm	25mm	83mm	Per project spec
DPC1045	25mm	38mm	70mm	Per project spec

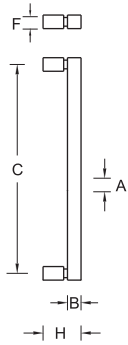

Model	A	B	H	C
DPC1011	25mm	38mm	70mm	Per project spec
DPC1029	38mm	25mm	70mm	Per project spec

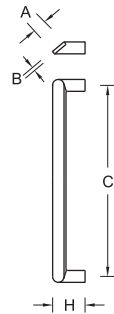

Model	A	B	H	C
DPC1030	28mm	6mm	60mm	Per project spec

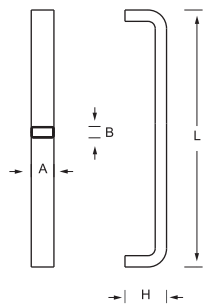

Model	A	B	H	C
DPC1035	30mm	15mm	70mm	Per project spec

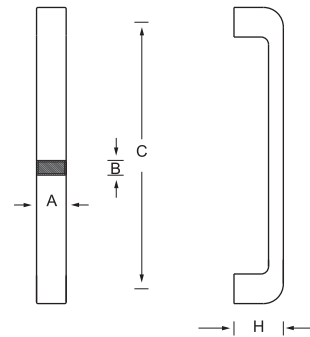

Model	A	B	H	C
DPC1042	30mm	15mm	50mm	Per project spec

RECTANGULAR GRIP CROSS SECTION PULLS

INFINITY MOUNTED—STRAIGHT PULLS

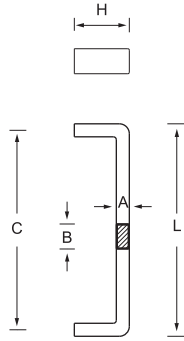

Model	A	B	H	C
DPC1043	25mm	13mm	55mm	Per project spec

VARIED GRIP CROSS SECTION PULLS



INFINITY MOUNTED—STRAIGHT PULLS

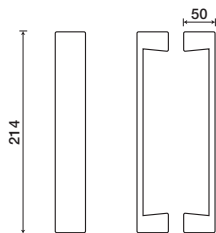

Model
DPE1020 Siena

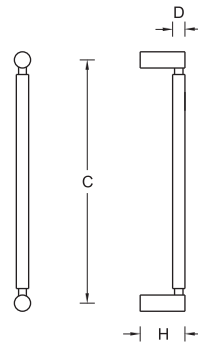

Model	D	H	C
DPE1022	∅ 25mm	75mm	Per project spec
DPE1023	∅ 32mm	80mm	Per project spec

VARIED GRIP CROSS SECTION PULLS

INFINITY MOUNTED—STRAIGHT PULLS

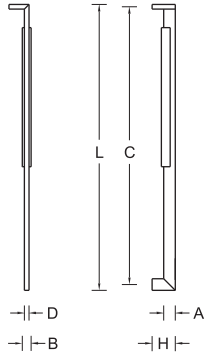

Model	A	B	H	C
DPE1033	50mm	38mm	100mm	Per project spec

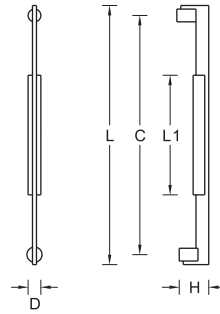

Model	D	H	C and L
DPE1037	∅ 32mm	80mm	Per project spec
DPE1038	∅ 38mm	85mm	Per project spec

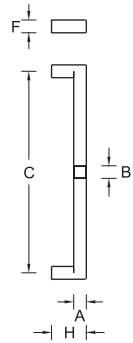

Model	A	B	F	H	C
DPE1039	25mm	25mm	∅ 25mm	70mm	Per project spec
DPE1040	30mm	30mm	∅ 30mm	75mm	Per project spec

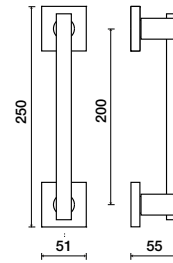

Model
DPE1020 Siena

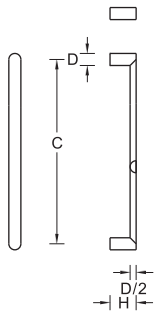

Model	D	2	H	C
DPE1043	25mm	12.5mm	65mm	Per project spec
DPE1044	32mm	16mm	70mm	

ROUND GRIP CROSS SECTION PULLS

INFINITY MOUNTED—OFFSET PULLS

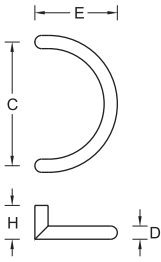

Model	D	H	C and E
DPA1005	∅ 25mm	70mm	Per project spec
DPA1010	∅ 32mm	80mm	Per project spec

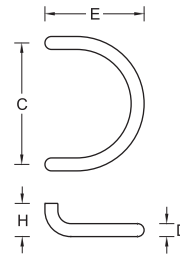

Model	D	H	C and E
DPA1007	∅ 25mm	75mm	Per project spec
DPA1008	∅ 32mm	80mm	Per project spec

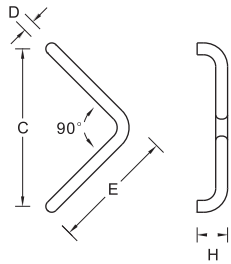

Model	D	H	C and E
DPA1012	∅ 25mm	75mm	Per project spec
DPA1013	∅ 32mm	80mm	Per project spec

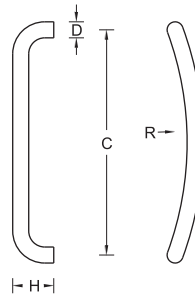

Model	D	H	C and R
DPA1014	∅ 25mm	75mm	Per project spec
DPA1015	∅ 32mm	80mm	Per project spec

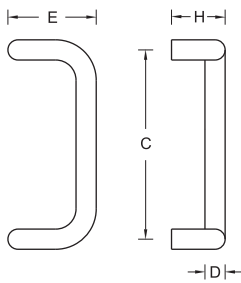

Model	D	H	C and E
DPA1016	∅ 25mm	75mm	Per project spec
DPA1017	∅ 32mm	80mm	Per project spec

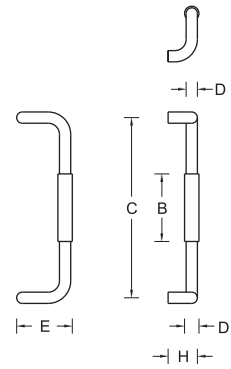

Model	D	D1	H	C
DPA1023	∅ 25mm	∅ 32mm	75mm	Per project spec

ROUND GRIP CROSS SECTION PULLS

INFINITY MOUNTED—OFFSET PULLS

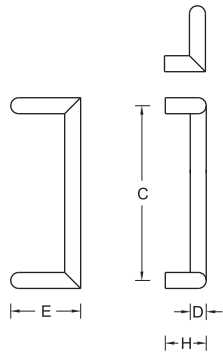

Model	D	H	C and E
DPA1028	∅ 25mm	70mm	Per project spec
DPA1029	∅ 32mm	80mm	Per project spec

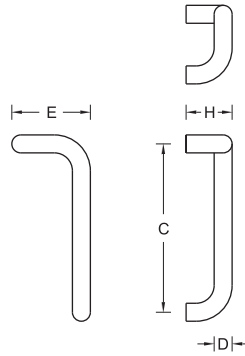

Model	D	H	C and E
DPA1038	∅ 25mm	75mm	Per project spec
DPA1039	∅ 32mm	80mm	Per project spec

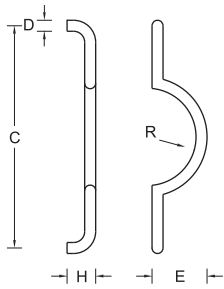

Model	D	H	C and R
DPA1040	∅ 25mm	65mm	Per project spec

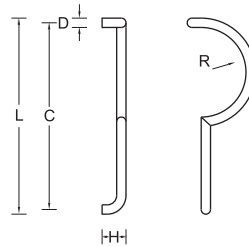

Model	D	H	C and R
DPA1041	∅ 25mm	70mm	Per project spec
DPA1042	∅ 32mm	77mm	Per project spec

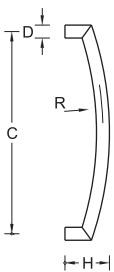

Model	D	H	C and R
DPA1045	∅ 25mm	110mm	Per project spec
DPA1046	∅ 32mm	118mm	Per project spec

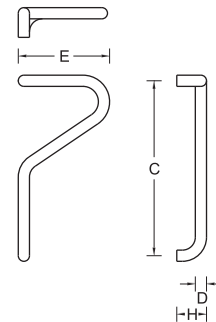

Model	D	H	C and E
DPA1048	∅ 25mm	80mm	Per project spec
DPA1049	∅ 32mm	85mm	Per project spec

ROUND GRIP CROSS SECTION PULLS

INFINITY MOUNTED—OFFSET PULLS

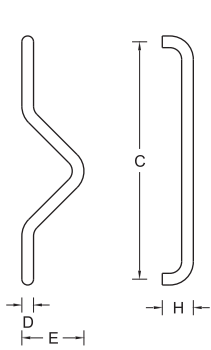

Model	D	H	C and E
DPA1050	∅ 25mm	80mm	Per project spec
DPA1051	∅ 32mm	85mm	Per project spec

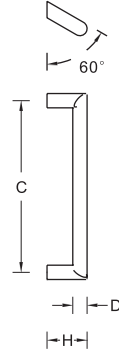

Model	D	H	C
DPA1052	∅ 25mm	70mm	Per project spec
DPA1053	∅ 32mm	77mm	Per project spec

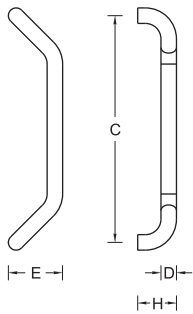

Model	D	H	C and E
DPA1055	∅ 32mm	80mm	Per project spec

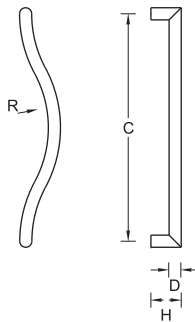

Model	D	H	C and R
DPA1056	∅ 25mm	70mm	Per project spec
DPA1057	∅ 32mm	77mm	Per project spec

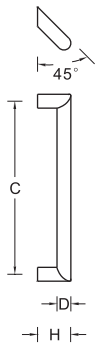

Model	D	H	C
DPA1069	∅ 32mm	77mm	Per project spec
DPA1070	∅ 25mm	70mm	Per project spec

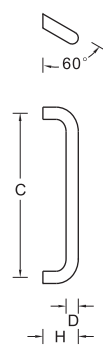

Model	D	H	C
DPA1071	∅ 32mm	80mm	Per project spec
DPA1072	∅ 25mm	75mm	Per project spec

ROUND GRIP CROSS SECTION PULLS

INFINITY MOUNTED—OFFSET PULLS

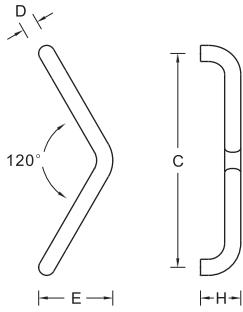

Model	D	H	C and E
DPA1073	∅ 32mm	80mm	Per project spec
DPA1074	∅ 25mm	75mm	Per project spec

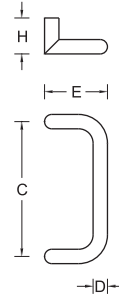

Model	D	H	C and E
DPA1077	∅ 32mm	80mm	Per project spec
DPA1078	∅ 25mm	75mm	Per project spec

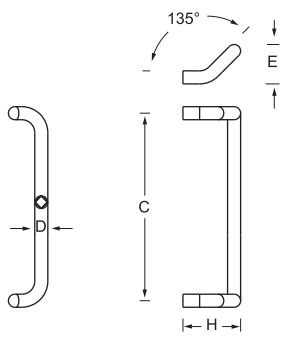

Model	D	H	C and E
DPA1086	∅ 19mm	84mm	Per project spec

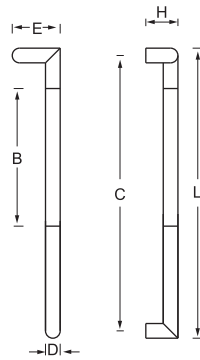

Model	D	H	C and E
DPA1087	∅ 32mm	70mm	Per project spec

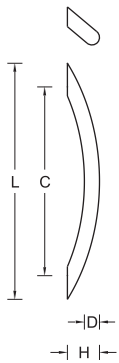

Model	D	H	C
DPA1105	∅ 25mm	60mm	Per project spec
DPA1106	∅ 32mm	68mm	Per project spec

SQUARE GRIP CROSS SECTION PULLS

B

INFINITY MOUNTED—OFFSET PULLS

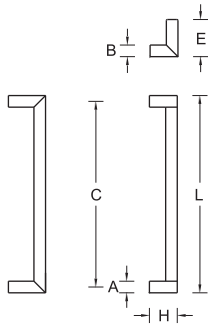

Model	A	B	H	C and E
DPB1003	25mm	25mm	70mm	Per project spec

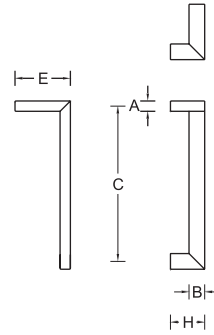

Model	A	B	H	C and E
DPB1004	25mm	25mm	70mm	Per project spec

RECTANGULAR GRIP CROSS SECTION PULLS

C

INFINITY MOUNTED—OFFSET PULLS

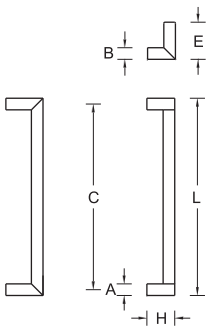

Model	A	B	H	C and E
DPC1000	25mm	13mm	58mm	Per project spec
DPC1014	13mm	25mm	70mm	Per project spec
DPC1015	38mm	25mm	70mm	Per project spec
DPC1016	25mm	38mm	83mm	Per project spec

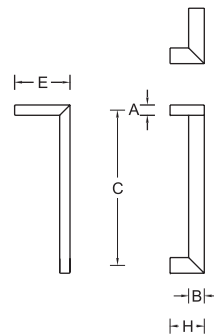

Model	A	B	H	C and E
DPC1018	25mm	13mm	58mm	Per project spec
DPC1019	13mm	25mm	70mm	Per project spec
DPC1020	38mm	25mm	70mm	Per project spec
DPC1021	25mm	38mm	83mm	Per project spec

RECTANGULAR GRIP CROSS SECTION PULLS

INFINITY MOUNTED—OFFSET PULLS

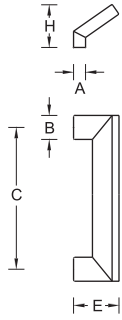

Model	A	B	H	C
DPC1031	20mm	40mm	72mm	Per project spec

VARIED GRIP CROSS SECTION PULLS



INFINITY MOUNTED—OFFSET PULLS

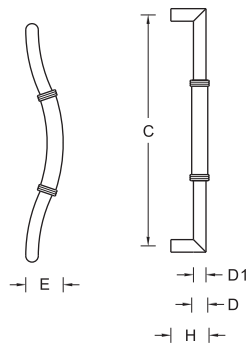

Model	D	D1	H	C and F
DPE1024	Ø 32mm	Ø 25mm	70mm	Per project spec

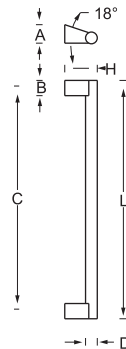

Model	D	H	C
DPE1035	Ø 40mm	70mm	Per project spec

VARIED GRIP CROSS SECTION PULLS

INFINITY MOUNTED—OFFSET PULLS

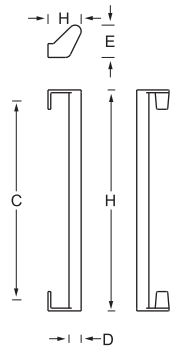

Model	D	H	C
DPE1036	∅ 22mm	60mm	Per project spec

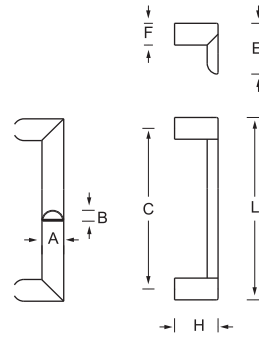

Model	D	H	C
DPE1042	∅ 30mm	80mm	Per project spec

STANDOFF MOUNTED PULLS

Standoff mounted pulls have mounting posts fastened to the grip as a separate component.



ROUND GRIP CROSS SECTION PULLS

STANDOFF MOUNTED—STRAIGHT PULLS

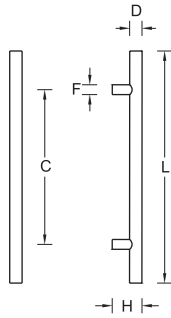

Model	D	F	H	C
DPA4000	∅ 32mm	∅ 25mm	77mm	Per project spec
DPA4002	∅ 32mm	∅ 25mm	77mm	Per project spec
DPA4004	∅ 32mm	∅ 25mm	77mm	Per project spec
DPA4005	∅ 25mm	∅ 22mm	70mm	Per project spec

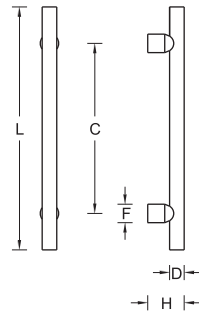

Model	D	F	H	C
DPA4008	∅ 25mm	∅ 32mm	70mm	Per project spec
DPA4009	∅ 32mm	∅ 38mm	77mm	Per project spec

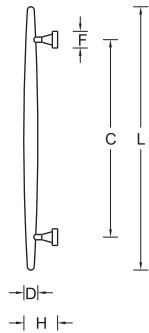

Model	D	F	H	C
DPA4010	∅ 32mm	∅ 38mm	76mm	Per project spec

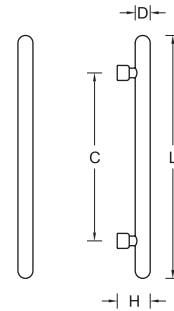

Model	D	F	H	C
DPA4013	∅ 22mm	∅ 22mm	75mm	Per project spec
DPA4014	∅ 25mm	∅ 25mm	82mm	Per project spec

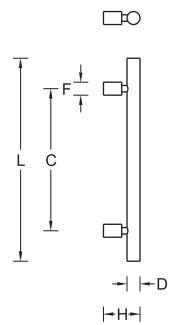

Model	D	F	H	C
DPA4017	∅ 25mm	∅ 25mm	85mm	Per project spec
DPA4018	∅ 32mm	∅ 32mm	92mm	Per project spec

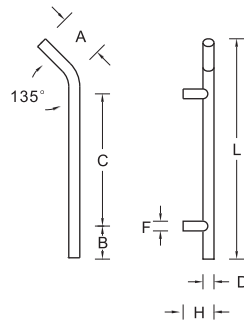

Model	D	F	H	C
DPA4021	∅ 25mm	∅ 22mm	70mm	Per project spec
DPA4022	∅ 32mm	∅ 25mm	77mm	Per project spec

ROUND GRIP CROSS SECTION PULLS

STANDOFF MOUNTED—STRAIGHT PULLS

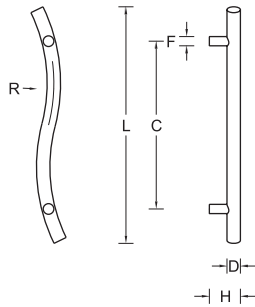

Model	D	F	H	C
DPA4023	∅ 25mm	∅ 22mm	70mm	Per project spec
DPA4024	∅ 32mm	∅ 25mm	77mm	Per project spec

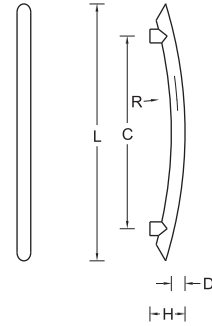

Model	D	F	H	C
DPA4026	∅ 25mm	∅ 25mm	75mm	Per project spec
DPA4027	∅ 32mm	∅ 32mm	82mm	Per project spec

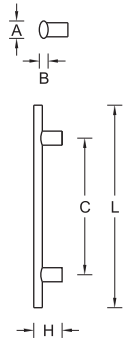

Model	D	F	H	C
DPA4041	∅ 40mm	∅ 40mm	65mm	Per project spec

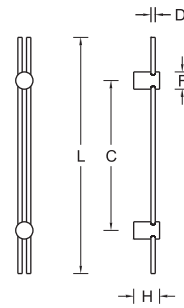

Model	D	F	H	C
DPA4045	∅ 10mm	∅ 40mm	60mm	Per project spec

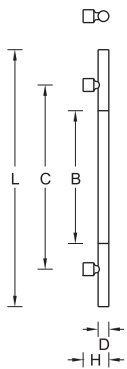

Model	D	F	H	C
DPA4049	∅ 25mm	∅ 25mm	60mm	Per project spec

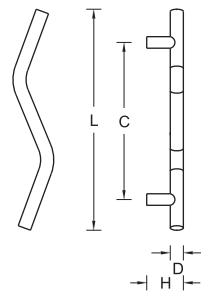

Model	D	F	H	C
DPA4050	∅ 25mm	∅ 25mm	70mm	Per project spec
DPA4051	∅ 32mm	∅ 32mm	77mm	Per project spec

ROUND GRIP CROSS SECTION PULLS

STANDOFF MOUNTED—STRAIGHT PULLS



Model	D	F	H	C
DPA4052	∅ 25mm	∅ 25mm	70mm	Per project spec
DPA4053	∅ 32mm	∅ 32mm	77mm	Per project spec

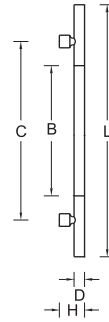

Model	D	F	H	C
DPA4054	∅ 25mm	∅ 25mm	60mm	Per project spec
DPA4055	∅ 32mm	∅ 32mm	72mm	Per project spec

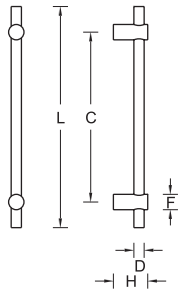

Model	D	F	H	C
DPA4063	∅ 16mm	∅ 22mm	60mm	Per project spec
DPA4064	∅ 19mm	∅ 25mm	70mm	Per project spec
DPA4065	∅ 20mm	∅ 30mm	70mm	Per project spec



Model	D	F	H	C
DPA4066	∅ 19mm	∅ 25mm	65mm	Per project spec
DPA4067	∅ 25mm	∅ 30mm	70mm	Per project spec

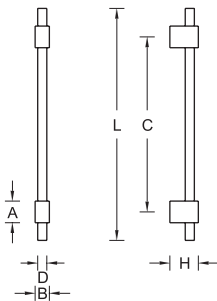

Model	D	A	B	H	C
DPA4070	∅ 16mm	38mm	25mm	60mm	Per project spec
DPA4071	∅ 19mm	38mm	25mm	65mm	Per project spec

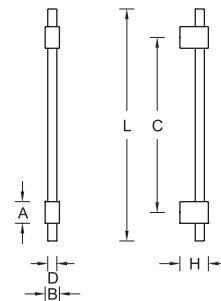

Model	D	A	B	H	C
DPA4072	∅ 21.5mm	22mm	17mm	64mm	Per project spec
DPA4073	∅ 25.2mm	25mm	19mm	67mm	Per project spec

ROUND GRIP CROSS SECTION PULLS

STANDOFF MOUNTED—STRAIGHT PULLS

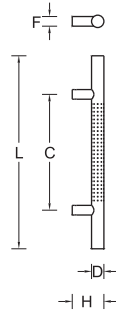
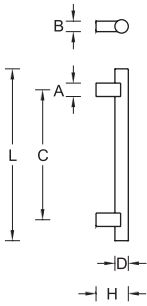

Model	D	A	B	H	C	Model	D	F	H	C
DPA4074	∅ 32mm	32mm	32mm	77mm	Per project spec	DPA4080	∅ 25mm	∅ 22mm	60mm	Per project spec
DPA4075	∅ 38mm	38mm	38mm	83mm	Per project spec	DPA4081	∅ 32mm	∅ 25mm	67mm	Per project spec

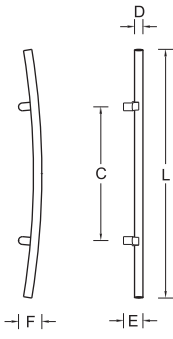
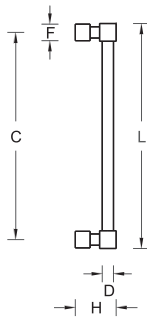

Model	D	F	H	C	Model	D	F	H	C
DPA4084	∅ 19mm	∅ 28mm	69mm	Per project spec	DPA4086	∅ 22mm		50mm	Per project spec
DPA4085	∅ 22mm	∅ 32mm	77mm	Per project spec					

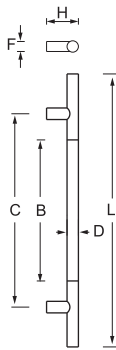
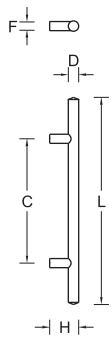

Model	D	F	H	C	Model	D	F	H	C
DPA4089	∅ 25mm	∅ 22mm	70mm	Per project spec	DPA4096	∅ 25mm	∅ 22mm	60mm	Per project spec
DPA4090	∅ 30mm	∅ 25mm	75mm	Per project spec	DPA4097	∅ 32mm	∅ 25mm	72mm	Per project spec

ROUND GRIP CROSS SECTION PULLS

STANDOFF MOUNTED—STRAIGHT PULLS

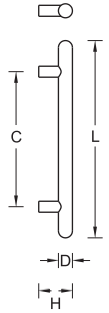

Model	D	F	H	C
DPA4106	∅ 25mm	∅ 25mm	70mm	Per project spec
DPA4107	∅ 32mm	∅ 32mm	77mm	Per project spec

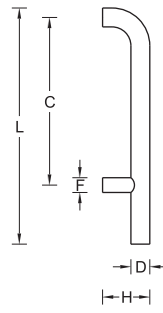

Model	D	F	H	C
DPA4108	∅ 25mm	∅ 22mm		Per project spec
DPA4109	∅ 32mm	∅ 25mm		Per project spec

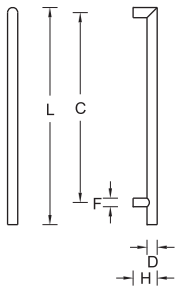

Model	D	F	H	C
DPA4110	∅ 25mm	∅ 22mm	70mm	Per project spec
DPA4111	∅ 32mm	∅ 25mm	75mm	Per project spec

SQUARE GRIP CROSS SECTION PULLS

STANDOFF MOUNTED—STRAIGHT PULLS

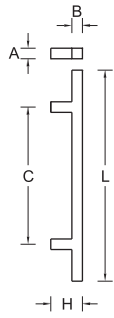

Model	A	B	H	C
DPB4000	30mm	30mm	75mm	Per project spec
DPB4005	25mm	25mm	70mm	Per project spec
DPB4006	20mm	20mm	65mm	Per project spec

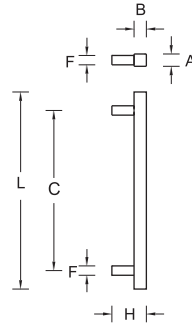

Model	A	B	F	H	C
DPB4001	25mm	25mm	∅ 19mm	70mm	Per project spec
DPB4002	25mm	25mm	∅ 22mm	70mm	Per project spec

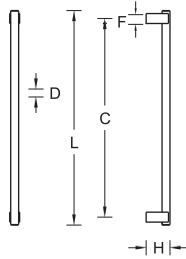

Model	D	F	H	C
DPB4003	16mm	16mm	60mm	Per project spec
DPB4004	19mm	19mm	60mm	Per project spec

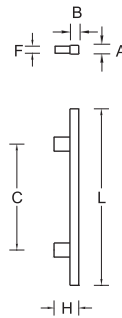

Model	A	B	F	H	C
DPB4012	25mm	25mm	20mm	70mm	Per project spec
DPB4013	30mm	30mm	25mm	75mm	Per project spec

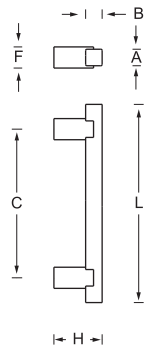

Model	A	B	F	H	C
DPB4014	25mm	25mm	32mm	73mm	Per project spec

RECTANGULAR GRIP CROSS SECTION PULLS

STANDOFF MOUNTED—STRAIGHT PULLS

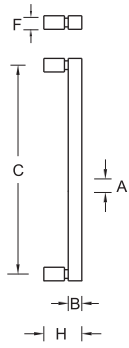

Model	A	B	F	H	C
DPC4000	38mm	25mm	25mm	70mm	Per project spec

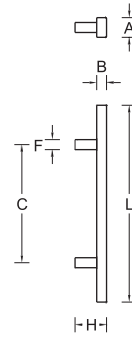

Model	A	B	F	H	C
DPC4010	40mm	20mm	20mm	65mm	Per project spec
DPC4011	50mm	25mm	25mm	70mm	Per project spec

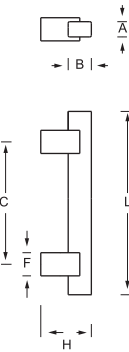

Model	A	B	F	H	C
DPC4013	25mm	38mm	38mm	83mm	Per project spec

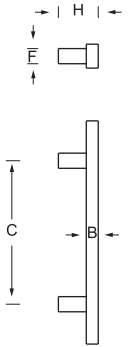

Model	A	B	F	H	C
DPC4014	30mm	15mm	19mm	50mm	Per project spec

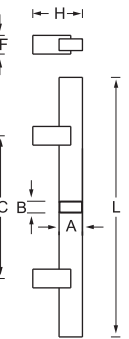

Model	A	B	F	H	C
DPC4015	40mm	20mm	∅ 30mm	85mm	Per project spec

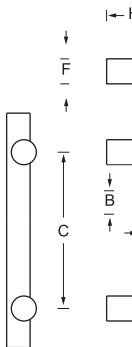

Model	A	B	F	H	C
DPC4016	15mm	30mm	∅ 32mm	70mm	Per project spec
DPC4017	15mm	30mm	∅ 32mm	85mm	Per project spec

RECTANGULAR GRIP CROSS SECTION PULLS

C

STANDOFF MOUNTED—STRAIGHT PULLS

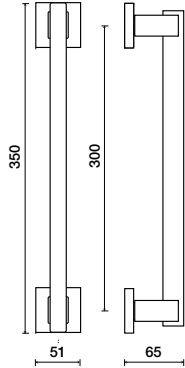

Model
DPC4021 Join

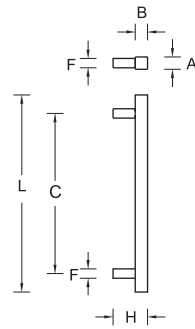

Model	A	B	F	H	C
DPC4023	40mm	20mm	∅ 22mm	70mm	Per project spec

OVAL GRIP CROSS SECTION PULLS

D

STANDOFF MOUNTED—STRAIGHT PULLS

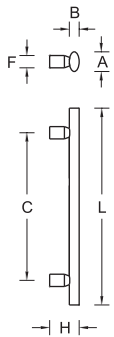

Model	A	B	F	H	C
DPD4000	40mm	20mm	∅ 25mm	60mm	Per project spec

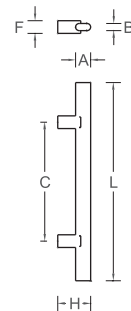

Model	A	B	F	H	C
DPD4004	38mm	18mm	∅ 32mm	83mm	Per project spec
DPD4005	45mm	25mm	∅ 38mm	90mm	Per project spec

VARIED GRIP CROSS SECTION PULLS

STANDOFF MOUNTED—STRAIGHT PULLS

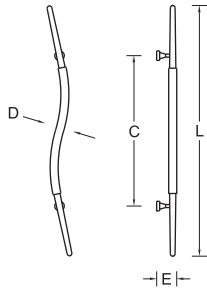

Model	D	F	H	C
DPE4002	Ø 21mm	21mm	53mm	Per project spec

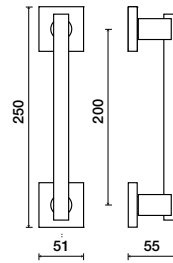

Model
DPE4026 Kale

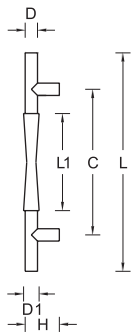

Model	D	F	H	C
DPE4027	Ø 19mm	19mm	70mm	Per project spec

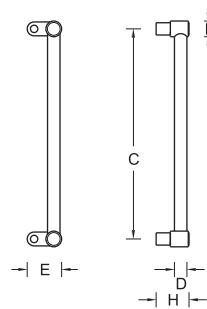

Model	D	F	H	C
DPE4028	Ø 25mm	Ø 35mm	67mm	Per project spec

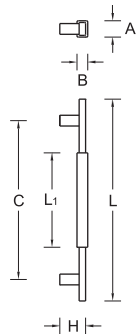

Model	D	F	H	C
DPE4029	Ø 8mm	Ø 25mm	60mm	Per project spec

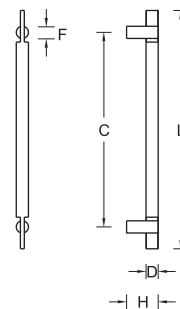

Model	D	F	H	C
DPE4030	Ø 25mm	Ø 25mm	70mm	Per project spec
DPE4031	Ø 32mm	Ø 32mm	77mm	Per project spec

VARIED GRIP CROSS SECTION PULLS

STANDOFF MOUNTED—STRAIGHT PULLS

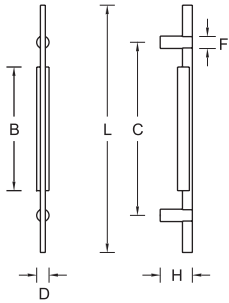

Model	D	F	H	C
DPE4032	∅ 25mm	∅ 25mm	65mm	Per project spec
DPE4033	∅ 32mm	∅ 32mm	75mm	Per project spec

ROUND GRIP CROSS SECTION PULLS

STANDOFF MOUNTED—OFFSET PULLS

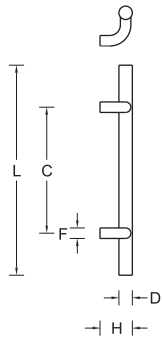

Model	D	F	H	C
DPA4011	∅ 25mm	∅ 22mm	75mm	Per project spec
DPA4012	∅ 32mm	∅ 25mm	80mm	Per project spec

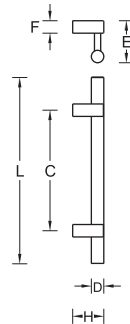

Model	D	F	H	C
DPA4015	∅ 25mm	∅ 25mm	70mm	Per project spec
DPA4016	∅ 32mm	∅ 32mm	80mm	Per project spec

ROUND GRIP CROSS SECTION PULLS

STANDOFF MOUNTED—OFFSET PULLS

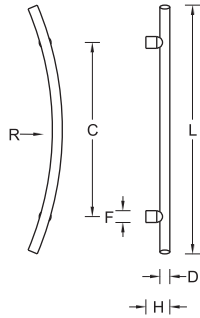

Model	D	F	H	C
DPA4019	∅ 25mm	∅ 32mm	70mm	Per project spec
DPA4020	∅ 32mm	∅ 38mm	77mm	Per project spec

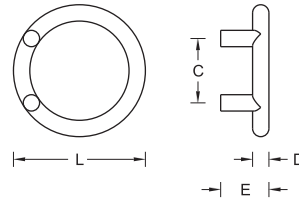

Model	D	F	H	C
DPA4025	∅ 25mm		75mm	Per project spec

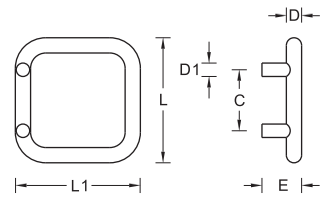

Model	D	F	H	C
DPA4028	∅ 25mm	∅ 22mm	65mm	Per project spec

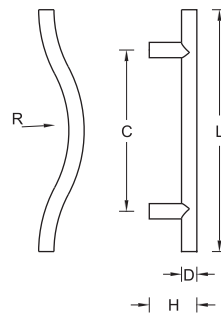

Model	D	F	H	C
DPA4035	∅ 25mm	∅ 25mm	70mm	Per project spec
DPA4036	∅ 32mm	∅ 32mm	77mm	Per project spec

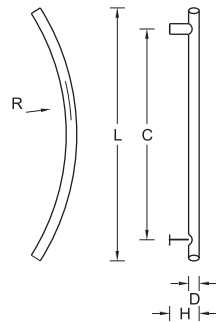

Model	D	F	H	C
DPA4039	∅ 25mm	∅ 25mm	70mm	Per project spec
DPA4040	∅ 32mm	∅ 32mm	77mm	Per project spec

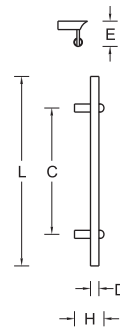

Model	D	F	H	C
DPA4042	∅ 20mm	∅ 20mm	70mm	Per project spec
DPA4043	∅ 25mm	∅ 25mm	75mm	Per project spec

ROUND GRIP CROSS SECTION PULLS

STANDOFF MOUNTED—OFFSET PULLS

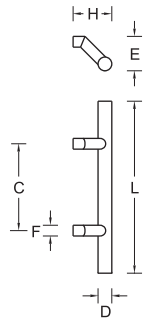

Model	D	F	H	C
DPA4048	Ø 32mm	Ø 32mm	90mm	Per project spec

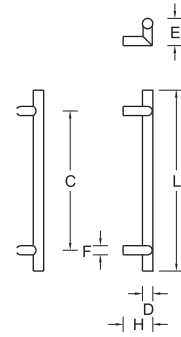

Model	D	F	H	C
DPA4056	Ø 25mm	Ø 22mm	70mm	Per project spec
DPA4057	Ø 32mm	Ø 22mm	77mm	Per project spec

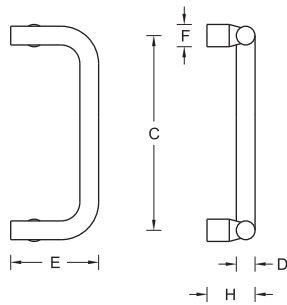

Model	D	F	H	C
DPA4060	Ø 25mm	Ø 32mm	70mm	Per project spec

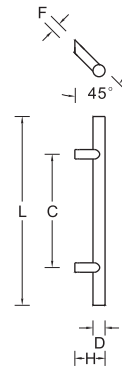

Model	D	F	H	C
DPA4061	Ø 25mm	Ø 22mm	70mm	Per project spec
DPA4062	Ø 32mm	Ø 25mm	77mm	Per project spec

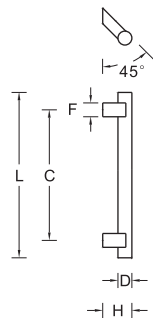

Model	D	F	H	C
DPA4068	Ø 32mm	Ø 32mm	67mm	Per project spec
DPA4069	Ø 38mm	Ø 38mm	73mm	Per project spec

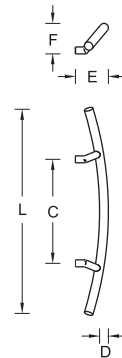

Model	D	F	H	C
DPA4079	Ø 25mm	25mm	95mm	Per project spec

ROUND GRIP CROSS SECTION PULLS

STANDOFF MOUNTED—OFFSET PULLS

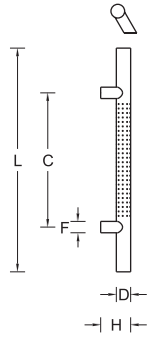

Model	D	F	H	C
DPA4082	∅ 25mm	∅ 25mm	60mm	Per project spec
DPA4083	∅ 32mm	∅ 25mm	67mm	Per project spec

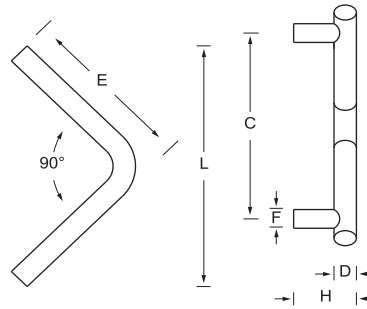

Model	D	F	H	C
DPA4087	∅ 25mm	∅ 22mm	70mm	Per project spec

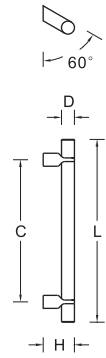

Model	D	F	H	C
DPA4091	∅ 32mm	∅ 32mm	77mm	Per project spec

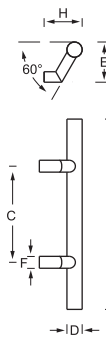

Model	D	F	H	C
DPA4092	∅ 32mm	∅ 22mm	80mm	Per project spec

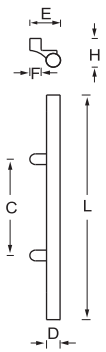

Model	D	F	H	C
DPA4095	∅ 30mm	∅ 30mm	67mm	Per project spec

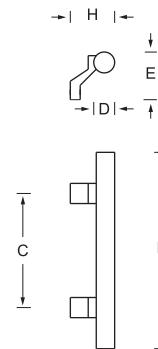

Model	D	F	H	C
DPA4098	∅ 25mm	∅ 25mm	54mm	Per project spec

ROUND GRIP CROSS SECTION PULLS

STANDOFF MOUNTED—OFFSET PULLS

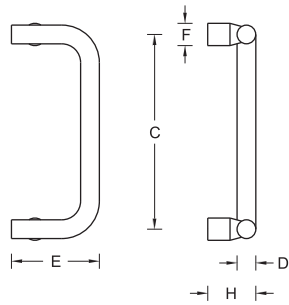

Model	D	F	H	C
DPA4103	∅ 32mm	∅ 38mm	77mm	Per project spec

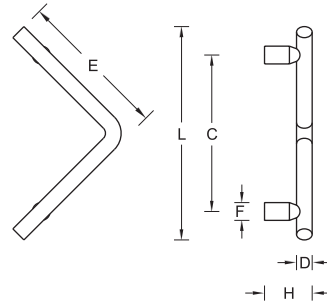

Model	D	F	H	C and E
DPA4104	∅ 25mm	∅ 32mm	70mm	Per project spec
DPA4105	∅ 32mm	∅ 38mm	77mm	Per project spec

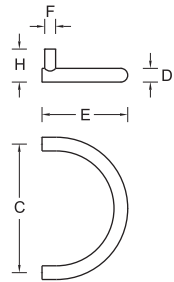

Model	D	F	H	C and E
DPA4112	∅ 25mm	∅ 22mm	70mm	Per project spec
DPA4113	∅ 32mm	∅ 25mm	77mm	

SQUARE GRIP CROSS SECTION PULLS

B

STANDOFF MOUNTED—OFFSET PULLS

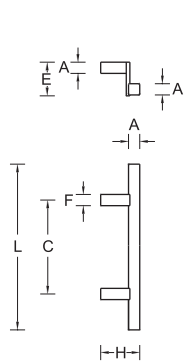

Model	A	F	H	C
DPB4008	20mm	20mm	82mm	Per project spec
DPB4009	25mm	25mm	87mm	Per project spec
DPB4010	30mm	30mm	92mm	Per project spec

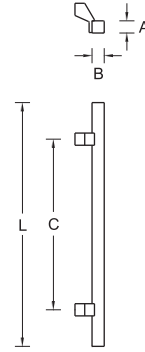

Model	A	B	H	C
DPB4011	25mm	25mm	67mm	Per project spec

RECTANGULAR GRIP CROSS SECTION PULLS

C

STANDOFF MOUNTED—OFFSET PULLS

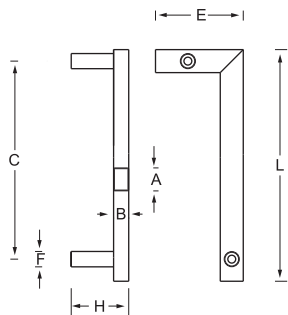

Model	A	B	F	H	C
DPC4024	38mm	25mm	∅ 25mm	95mm	Per project spec

OVAL GRIP CROSS SECTION PULLS

STANDOFF MOUNTED—OFFSET PULLS

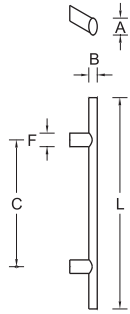

Model	A	B	F	H	C
DPD4006	40mm	20mm	∅ 32mm	65mm	Per project spec

SCULPTED PULLS

Sculpted pulls are contoured cast, asymmetric, and other creative design shapes beyond simple geometric shapes and components.



VARIED GRIP CROSS SECTION PULLS

SCULPTED—OFFSET PULLS

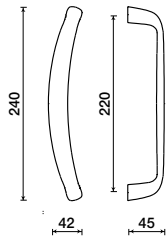

Model

DPE7021 Easy

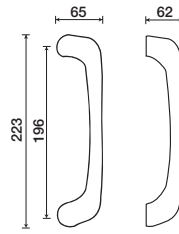

Model

DPE7022 Fenice

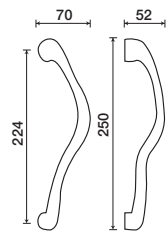

Model

DPE7023 Pavone

Custom Design and Manufacturing

FR International has an experienced and highly capable engineering department able to bring your ideas to life. We use 3D CAD design technology to engineer your ideas from concept to image renderings, and oversee through prototypes to production.

Shown here are a small sampling of various custom design projects that incorporated unique shapes or a variety of materials and finishes, including stainless steel, brass, aluminum, stone, leather, powder coating, and electroplating. We welcome the opportunity to create a custom solution for you.



LDP Locking Door Pull Program

In addition to the Architectural Door Pull Program presented in this catalog, FR International also offers the LDP Locking Door Pull Program which provides a variety of locking pulls and their matching non-locking complements. For details related to the LDP Program, please refer to our Locking Door Pull catalog brochure, available via download at FRInternational.com or via digital media.

Frascio locking door pulls add contemporary design and security functionality to door openings of all sizes. The concealed deadbolt locking system inside the pull provides a clean and elegant installation that eliminates the need for unsightly patch fittings or rails on glass door applications.

- ▶ Cylinder and turnknob located at a convenient height, reducing effort required to lock and unlock
- ▶ Multiple size, shape, design, and finish options and custom specification capability allow for unlimited combinations to meet your projects requirements

FEATURES

Heavy duty stainless steel construction

Multiple lengths available, including custom

Multiple shapes and designs available, including custom

Multiple operating configurations available; standard is key operated from exterior, turnknob from interior

Can be used with both swinging and sliding doors

Non-keyed privacy function available as well as matching non locking pulls

Multiple locking options: bottom bolt standard, top bolt, or dual locking available

Bolt location: approximately 2-5/8" from face of door to centerline of bolt

16mm stainless steel deadbolt with 32mm throw. Includes dust proof floor strike.

Accommodates most keying systems including standard non-interchangeable core, small format interchangeable core, large format interchangeable core, European profile, and other systems

Standard door thickness range: 8-19mm glass or solid panel;
1-3/4" to 2-1/4" aluminum, hollow metal, or wood doors

Available standard in satin and polished stainless steel finishes.
Other custom finishes available.





FR International, LLC
1011 3rd Avenue S.W.
Carmel, Indiana USA 46032
Tel: (317) 663-0030
Fax: (317) 663-0029
Toll Free: 1-800-238-9711
www.FRInternational.com